

# Standard Desk **Phase**

---

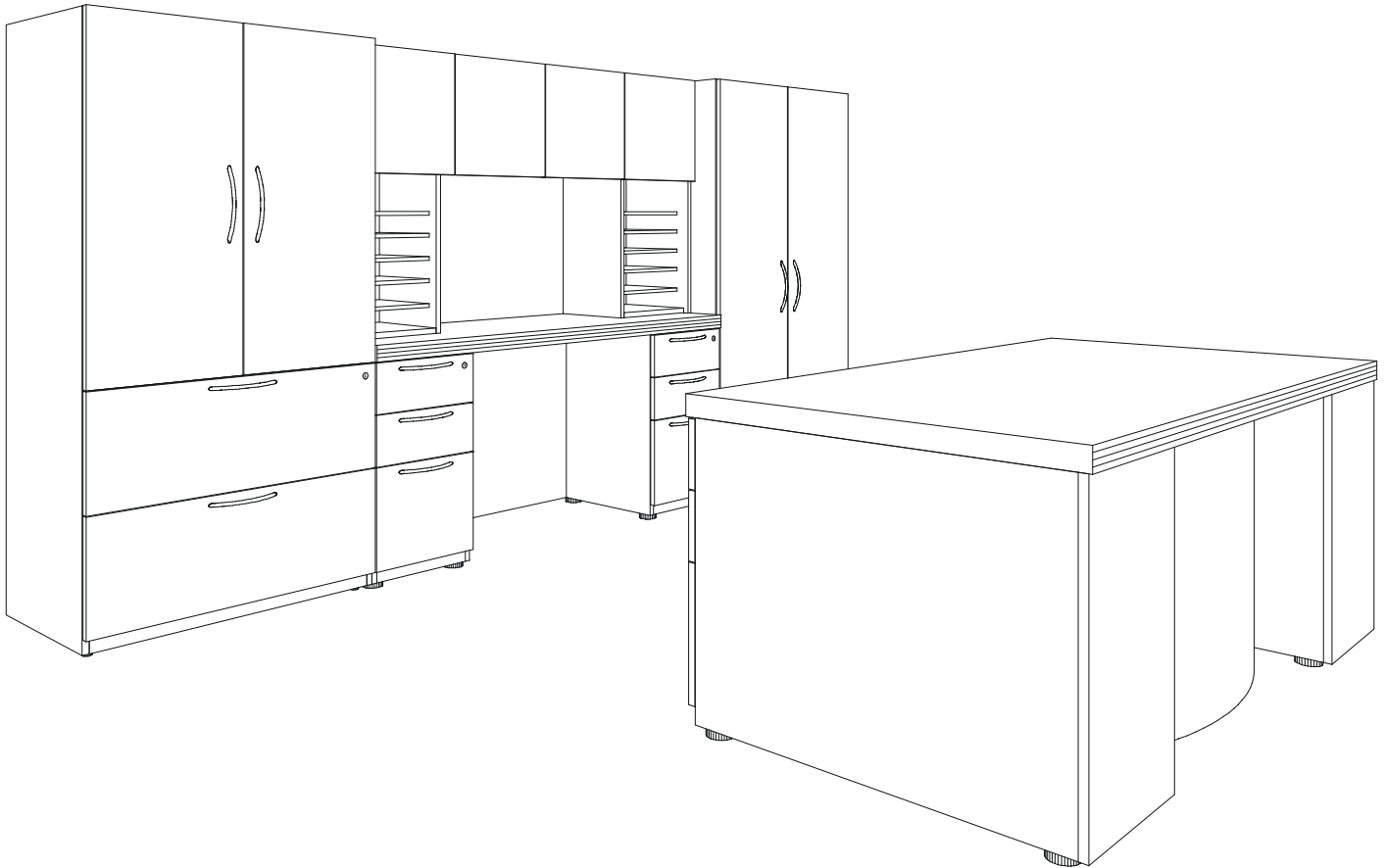

**Phase** is the ultimate tool for designing private office layouts that will reflect your creativity while remaining vastly flexible.

Components can be combined to fill both the fundamental requirements of today's technological work environments and the more personal requirements of the user.

With a myriad of edge, finish and component options, as well as a choice of two drawer pulls, creativity is free to explore endless possibilities.

Essentially, **Phase** can be used to capture an idea and make it a reality. It is set in the timeless beauty of natural wood and provides the added value of practical application.

**Phase**, in a nutshell, is choice and flexibility, elegance and style.

---

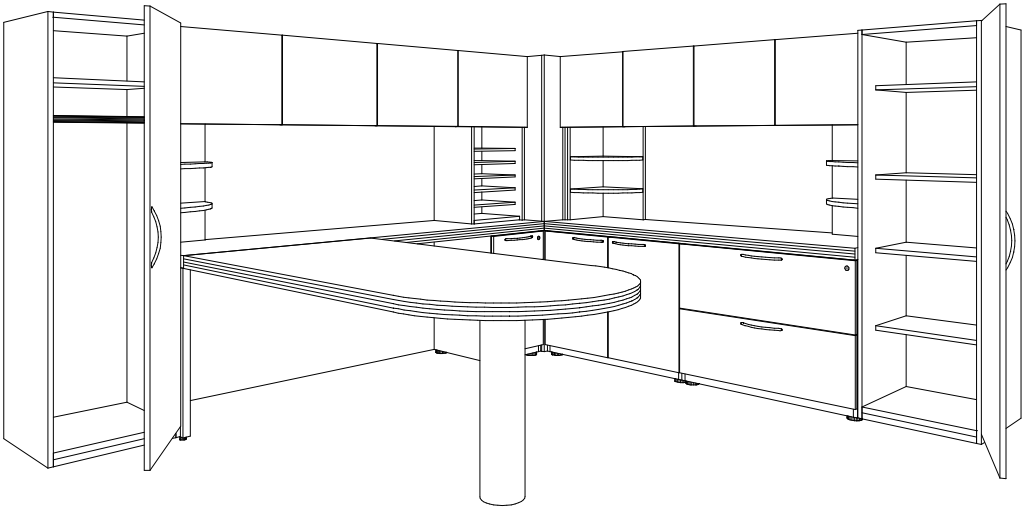
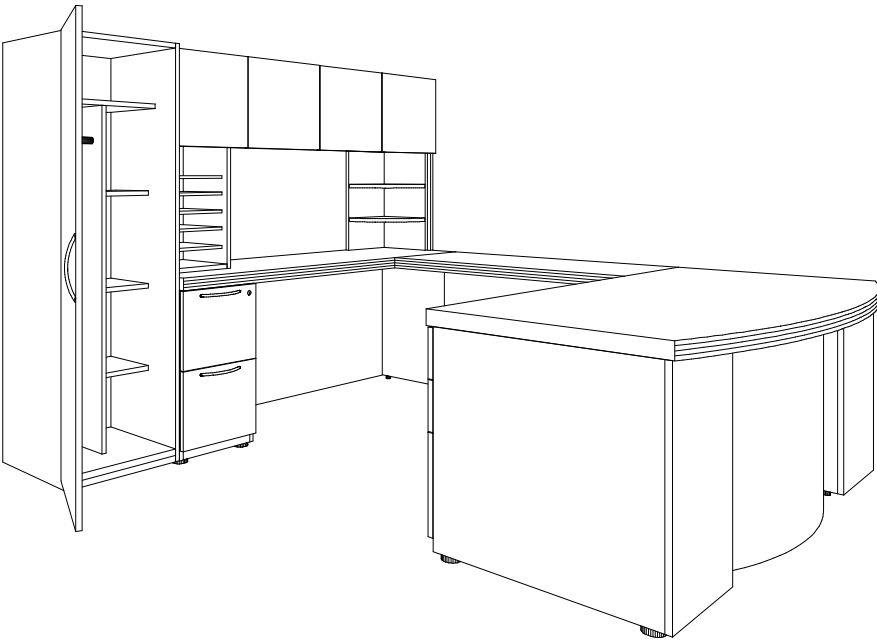

## Standard Desk **Phase**

---

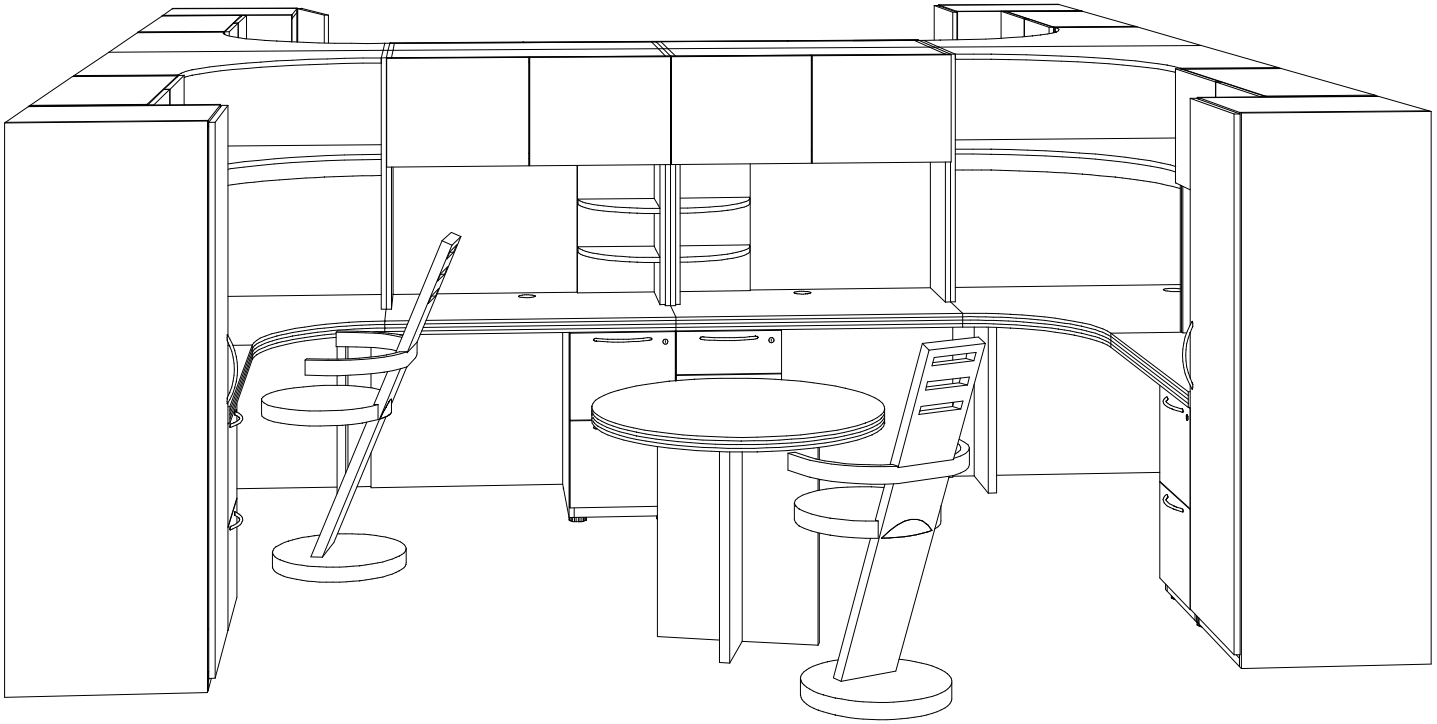

**Phase** is equally strong in serving the open-space concept by virtue of its flexibility.

With multiple wire-management tools available to complement the choice of elements, Phase stations will add a definitive style to an open space.

Stations can be built for individual employee requirements then multiplied or they can be combined to facilitate teamwork approaches, so popular in today's business world.

The ability to create compact, multi-purpose workstations is an unparalleled advantage in resolving space management issues.

**Phase** offers basic styling uniformity with gentle touches of diversity by using varying wood finish colours.

---

# Teamwork Stations

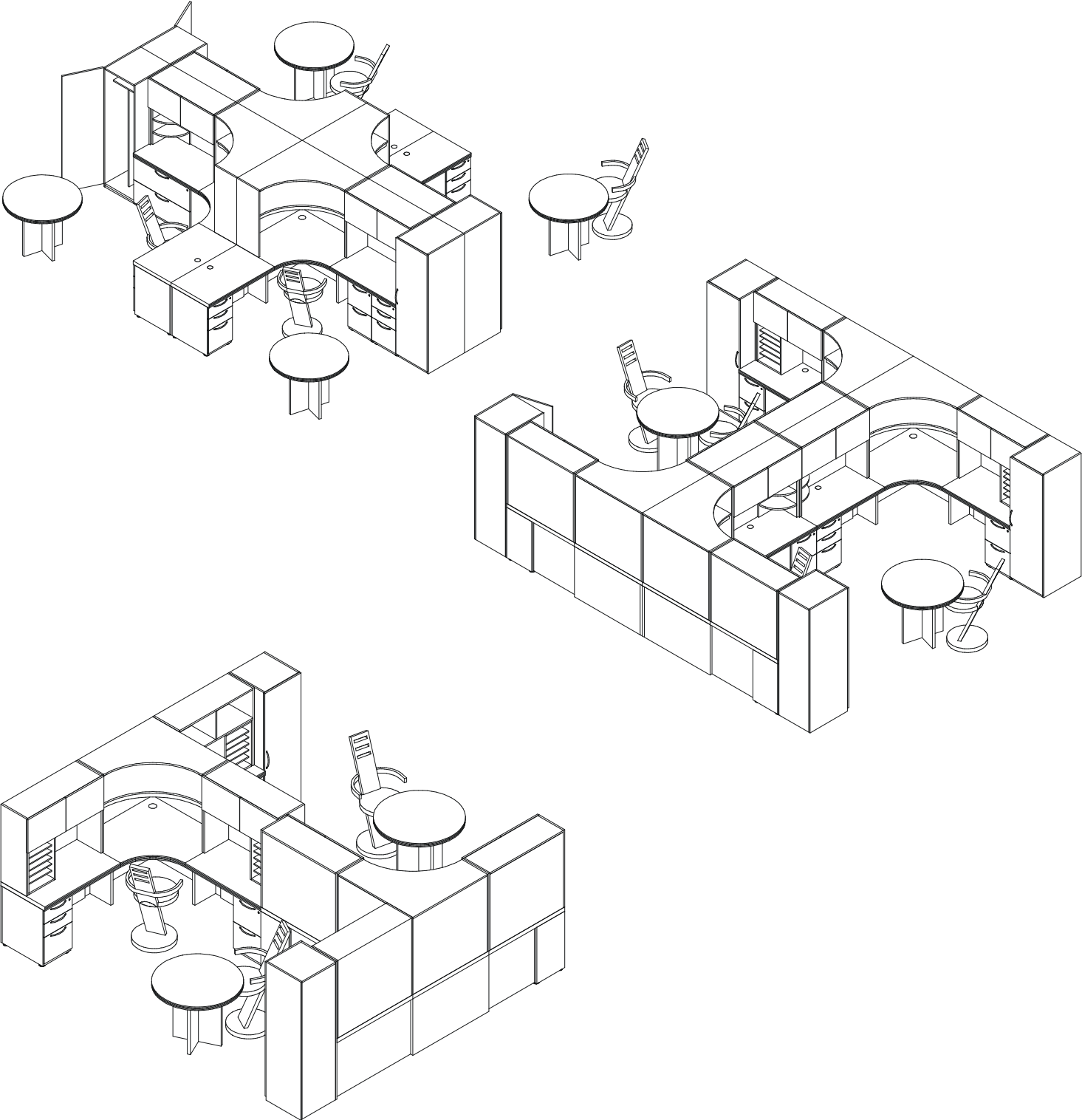

## Standard Desk Phase

---

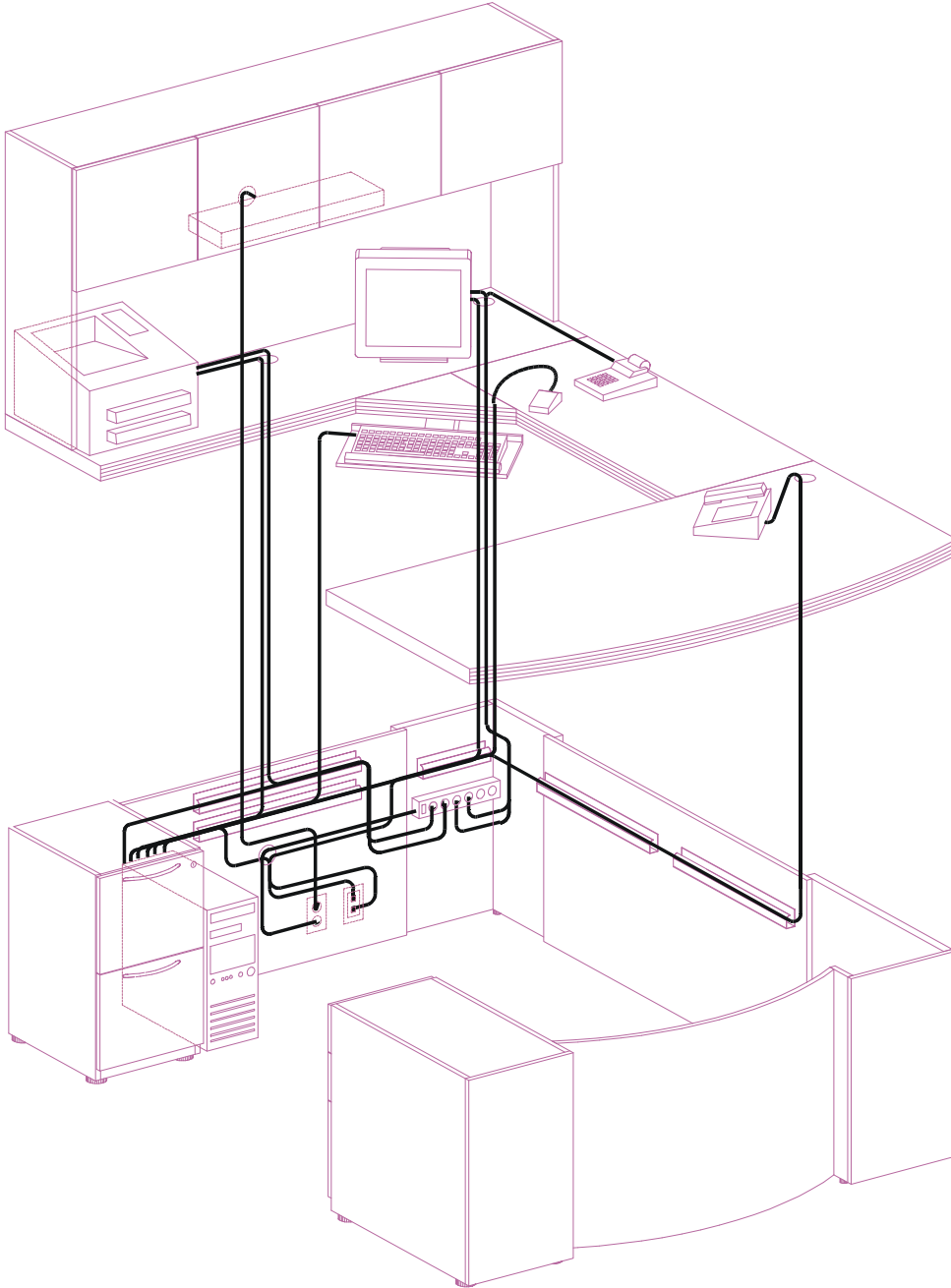

To answer the needs of high-tech work environments, various accessories can be added to channel communications and electric wiring, no matter how complex the station layout.

Using grommets and wire managers, wiring is neatly distributed and directed to its destination, whether ground power supply or wall outlets.

Adding task lighting and keyboard trays or drawers will ensure that all needs are met.

Hutch stationery organizers and closed or open door hutches complete any assembly, providing paper management and arms-length additional storage.

---

# Electric and Communications Wire Management

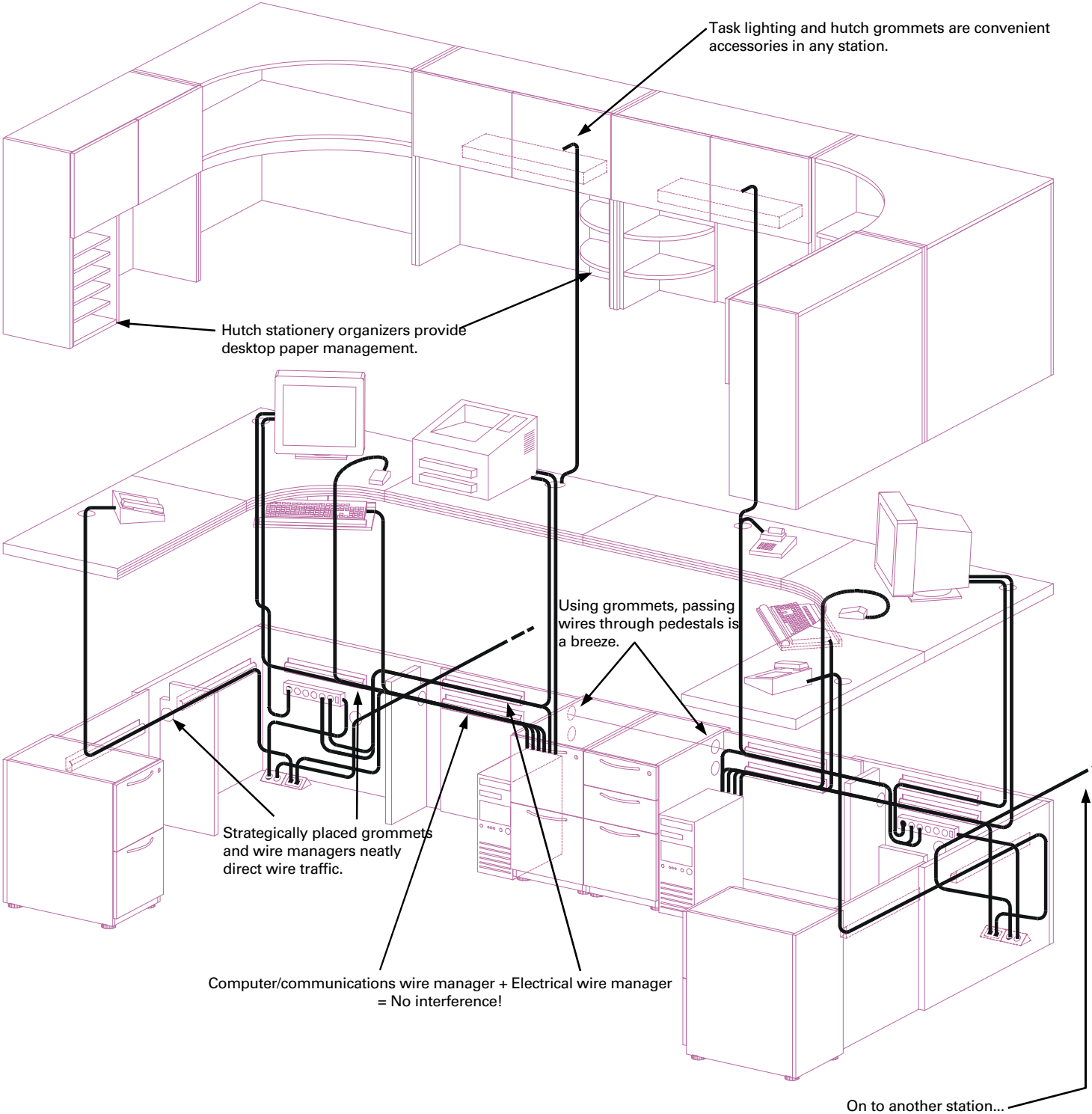



**Standard Desk**  
1000 St. Martin Blvd. West  
Laval, Quebec  
Canada  
H7S 1M7

Telephone: (450) 663-3030  
Telephone: (800)-363-6361  
Facsimile: (450) 663-9022  
info@StandardDesk.com